

Open Guide Bush

N 550



Suitability

Open guide bush with tapered inside edges on both sides.

- Allows universal use.
- When used in combination with shaft diameter d_w ISO-h3, preloading of the rotary stroke bearing is guaranteed.
- The ball cage can project out of the guide bush on both sides. This permits long stroke paths even with short guide bushes used in combination with long ball cages (note minimum contact length).

Features

- Guide bore diameter d_1 is finely honed to ISO tolerance IT 3, R_z 0.5 – 1.5 μm depending on diameter.
- Roundness within 1/3 ISO-IT 3.
- Cylindricity within IT 1.
- Radial run-out of a shaft inserted under preloading is within 0.0005 mm.
- Tapered inside edges on both sides ensure smooth running.
- Outside diameter d_B n4 with radial run-out error within IT 4, ground to guide bore diameter d_1 lead-in taper on one side.
- See page 37-41 for instructions on installation and servicing.

Material

- Special roller bearing steel 100 Cr 6 (1.2067 or 1.3505)
- Carefully heat-treated, hardness rating HRC 60–64/HV 720–815

Special designs

Other dimensions or designs based on workpiece drawings are available. These can also be produced using stainless steel (1.4112).

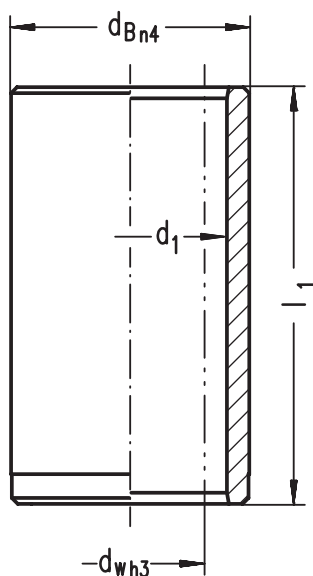

Order Information

Rotary stroke bearing consisting of:

Guide bush N 550/ $d_w/d_1/l_1$

Order No. 5002 . . .

Ball cage N 501/ $d_w/d_1/l_2$

Order No. 50010 . .

or

Ball cage N 500/ $d_w/d_1/l_2$

Order No. 50000 . .

or

Ball cage N 511/ $d_w/d_1/l_2$

Order No. 50011 . .