

## Open Guide Bush

### N 550 Mini Range

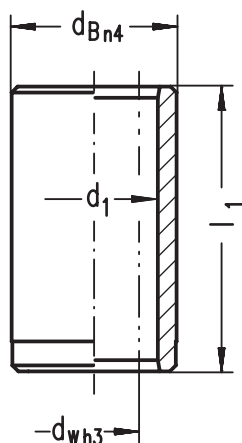
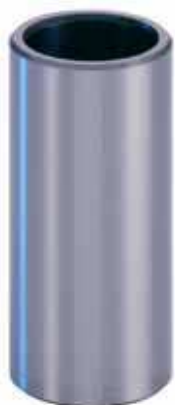

#### Suitability

Open guide bush with tapered inside edges on both sides for use with Mini Range ball cage N 502.

- Minimal installation space when used with Mini Range ball cages N 502.
- Allows universal use.
- When used in combination with shaft diameter  $d_w$  ISO-h3, preloading of the rotary stroke bearing is guaranteed.
- The ball cage can project out of the guide bush on both sides to permit longer stroke paths (note minimum contact length).

#### Features

- Guide bore diameter  $d_1$  is finely honed to ISO tolerance IT 3,  $R_z$  0.5 – 1.5  $\mu\text{m}$  depending on diameter.
- Roundness within 1/3 ISO-IT 3.
- Cylindricity within IT 1.
- Radial run-out of a shaft inserted under preloading is within 0.0005 mm.
- Tapered inside edges on both sides ensure smooth running.
- Outside diameter  $d_B$  n4 with radial run-out error within IT 4, ground to guide bore diameter  $d_1$ , lead-in taper on one side.
- See page 37-41 for instructions on installation and servicing.

#### Material

- Special roller bearing steel 100 Cr 6 (1.2067 or 1.3505)
- Carefully heat-treated, hardness rating HRC 60–64/HV 720–815

#### Special designs

Other dimensions or designs based on workpiece drawings are available. These can also be produced using stainless steel (1.4112).

#### Order Information

Rotary stroke bearing consisting of:

Guide bush N 550/ $d_w/d_1/l_1$

**Order No. 5002 . . .**

Ball cage N 502/ $d_w/d_1/l_2$

**Order No. 50002 . .**